

# Impress SDC Single Door Controller

ADALO Impress SDC Single Door Controller revolutionise the way you think about Access Control Solutions. Impress SDC comes in our award winning ELITE or PRESTIGE series which is as SMALL as your light switch but BIG on features which is not commonly found in professional standalone access controllers.

## Truly **SMALL** but **BIG** on Features

Although small in size, Impress SDC is able to enroll 10,000 card holders and have a full audit Trail of 10,000 events. Each Impress SDC will be able to connect up to 2 card readers for “in” and “out” verification coupled with Anti-Pass Back feature. A sensor is built into the Impress SDC where by you will only need to tap the Impress SDC to exit from the access control door.

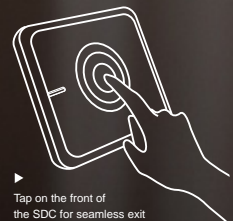

## Standalone

The Impress SDC can work as a standalone access controller. Uploading or downloading of programming parameters and audit trail can be seamlessly carried out via the use of a Trans-flash (TF) / Micro SD Card which is provided in every Impress SDC package. Once you have programmed the TF card with the Impress SDC parameters, just insert the TF Card into the Impress SDC and flash an authorised Manager card, the data synchronization will be done for you automatically. No longer would you need to walk to every single door controller to add/delete card holders or change programming parameters.

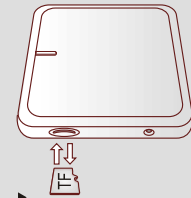

Provide a seamless wireless data management via a TF card

## Networked System

ADALO understands that you may have outgrown the usage of stand-alone solution and need to upgrade or expand your current access control solution. The Impress SDC is designed to cater for future expansion whereby the Impress SDC can be connected together to form an Access Control System. The Access Management Software (AMS) will be able to monitor in real time the status of the access control door.

## Security

The Impress SDC is designed to be placed in the “Secured” side of an access control door to improve the security of the access control door installation. The central processing unit and relay connections are not exposed to the “Unsecured” side, thereby reducing possibilities of sabotage or forced entry from unauthorised personnel. Protecting your access control data from unauthorised personnel is crucial to the integrity of your access control system. The data being written into the TF card from the upload / download of the AMS and Impress SDC is encrypted. Should you misplace the TF Card, the data written into the TF card cannot be deciphered.

## Access Management Software (AMS)

Whether standalone or networked together, Impress SDC will be able to link up with ADALO Access Management Software (AMS) for easy management of the access control door. The AMS is specifically designed to be intuitive and user friendly with a short learning curve even for first time users. The AMS software allows you to add /delete users, program time schedules and assign rights to the user on the access control door. The AMS will be able to generate customized reports with defined fields and the report can further be exported out to other third party software.

Features	Specifications		
<ul style="list-style-type: none"> <li>▪ 2 Wiegand input for card readers</li> <li>▪ Up to 10,000 card holders</li> <li>▪ Audit Trail of 10,000 events</li> <li>▪ Definable Card Expiry Date</li> <li>▪ Card Only / Card + PIN / User No. + PIN</li> <li>▪ Suitable for US / Asian Gang Box</li> <li>▪ Unlimited Time Schedule and Access Group</li> <li>▪ Duress Function with card reader with keypad</li> <li>▪ Built in Touch Sensor for Request to Exit</li> <li>▪ Adjustable Touch Sensor pressure</li> <li>▪ TF Card for easy uploading and downloading of data</li> <li>▪ Batch load for cards via AMS</li> <li>▪ Present cards to enroll through SDC</li> <li>▪ Generate customized reports</li> <li>▪ Easy to Use Access Management Software</li> <li>▪ Genuine Leather on Elite series(I510/I530/I550 SDC)</li> </ul>			
	Operating Voltage	DC 9 – 15V	
	Current Consumption	40 mA	
	Card Reader Input	2 Card Readers with wiegand output	
	Input	3 Dry Contact Input	
	Relay Output	1 Form C-relay (1A, 30V Rated)	
	Output	3 Open Collector Output (Less than 50mA)	
	LED	3 Colors: Red / Green / White	
	Audio	Built in Buzzer	
	Cable Distance	150m Wiegand Standard	
	Strike Time	1 ~ 999 Seconds (Programmable)	
	Door Ajar Time	1 ~ 999 Seconds (Programmable)	
	Entry / Exit	Card Only, Card + Pin, User No. + PIN	
	Anti-Pass Back	Programmable	
	Others	Programmable Maximum number of card holders in a defined area	
	Operating Temperature	-30°C ~ 65°C	
	Operating Humidity	0 ~ 80% RH, non-condensing	
Dimensions	95L*95W*21D(mm)		
Weight	130g		



I510 SDC    I530 SDC    I550 SDC    I630 SDC